

EL-QUINT

CONTROL POWER & TRAYS & GRP

3E Basor

CABLE TRAY SPECIALIST

System kanałów
kablowych z

PVC M1 V0
Basorplast
BPE



Dystrybutor w Polsce :

EL-QUINT Sp. z o.o.

ul. Gdańska 3D 70-660 Szczecin

tel. +48 914714470

www.elquint.com.pl

tworzywa@elquint.com.pl

biuro@elquint.com.pl



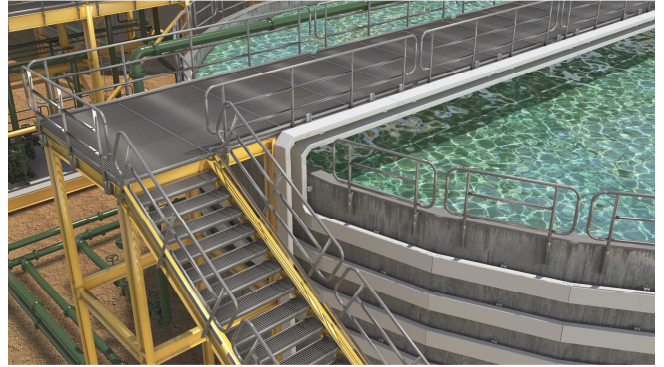

BASORPLAST

UNE-EN 61537
UNE-EN 50085

UNE-EN 61537
UNE-EN 50085
UNE 23727
UL94

UNE-EN 60695

UNE-EN 61537

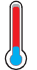
UNE-EN 50085



Mod. 60x100 10J
UNE-EN 61537
UNE-EN 50085



IEC 60529



IEC 50102

ISO/TR 10358
DIN 8061



TBPE

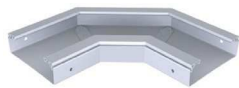

CPBPE



TCPBPE



CCBPE



TCCBPE



CXBPE



TCXBPE

PDBPE

TFBPE



JUBPE

JUBPE-AB

JUBPE-AB



CTBP



BASORPLAST

Kanał kablowy BPE-P / H60



| 3m (10ft) | ↑ | | → | | PVC M1 UV | KG/M |
|------------|----|--------|-----|------|---------------|-------------|
| | mm | inch | mm | inch | | |
| BPE 60X100 | 60 | 2 2/5" | 100 | 4" | 210070 | 0.73 |
| BPE 60X150 | 60 | 2 2/5" | 150 | 6" | 210071 | 0.98 |
| BPE 60X200 | 60 | 2 2/5" | 200 | 8" | 210072 | 1.45 |
| BPE 60X300 | 60 | 2 2/5" | 300 | 12" | 210073 | 2.34 |

2x +4

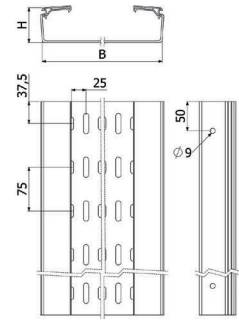

Kanał kablowy BPE-C / H60



| 3m (10ft) | ↑ | | → | | PVC M1 UV | KG/M |
|--------------|----|--------|-----|------|---------------|-------------|
| | mm | inch | mm | inch | | |
| BPE-C 60X100 | 60 | 2 2/5" | 100 | 4" | 210062 | 0.77 |
| BPE-C 60X150 | 60 | 2 2/5" | 150 | 6" | 210063 | 1.03 |
| BPE-C 60X200 | 60 | 2 2/5" | 200 | 8" | 210064 | 1.54 |
| BPE-C 60X300 | 60 | 2 2/5" | 300 | 12" | 210065 | 2.48 |

2x +4

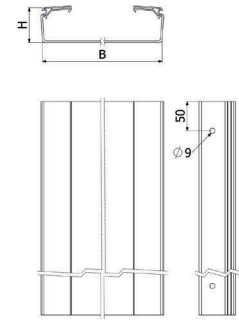

Kanał kablowy BPE-P / H100



| 3m (10ft) | ↑ | | → | | PVC M1 UV | KG/M |
|-------------|-----|------|-----|------|---------------|-------------|
| | mm | inch | mm | inch | | |
| BPE 100X200 | 100 | 4" | 200 | 8" | 210074 | 2.25 |
| BPE 100X300 | 100 | 4" | 300 | 12" | 210075 | 3.63 |
| BPE 100X400 | 100 | 4" | 400 | 16" | 210076 | 4.30 |
| BPE 100X600 | 100 | 4" | 600 | 24" | 210077 | 6.40 |

2x +8

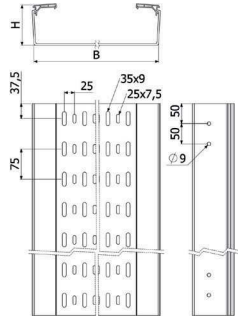

Kanał kablowy BPE-C / H100



| 3m (10ft) | ↑ | | → | | PVC M1 UV | KG/M |
|---------------|-----|------|-----|------|---------------|-------------|
| | mm | inch | mm | inch | | |
| BPE-C 100X200 | 100 | 4" | 200 | 8" | 210066 | 2.38 |
| BPE-C 100X300 | 100 | 4" | 300 | 12" | 210067 | 3.45 |
| BPE-C 100X400 | 100 | 4" | 400 | 16" | 210068 | 4.54 |
| BPE-C 100X600 | 100 | 4" | 600 | 24" | 210069 | 6.72 |

2x +8

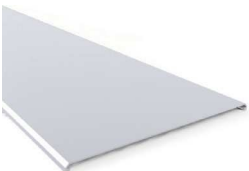
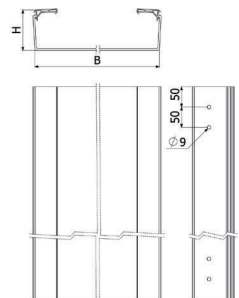

| | → | | PVC M1 UV | KG/M |
|----------|-----|------|---------------|-------------|
| | mm | inch | | |
| TBPE 150 | 150 | 6" | 210079 | 0.50 |
| TBPE 300 | 300 | 12" | 210081 | 1.10 |
| TBPE 600 | 600 | 24" | 210083 | 2.10 |

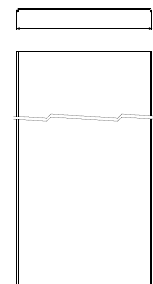

Zakręt poziomy 90° CPBPE



| | | | | | | |
|---------------|-----|--------|-----|-----|---------------|-------------|
| CPBPE 60X100 | 60 | 2 2/5" | 100 | 4" | 210089 | 0.40 |
| CPBPE 60X150 | 60 | 2 2/5" | 150 | 6" | 210090 | 0.54 |
| CPBPE 60X200 | 60 | 2 2/5" | 200 | 8" | 210091 | 0.91 |
| CPBPE 60X300 | 60 | 2 2/5" | 300 | 12" | 210092 | 1.61 |
| CPBPE 100X200 | 100 | 4" | 200 | 8" | 210093 | 1.24 |
| CPBPE 100X300 | 100 | 4" | 300 | 12" | 210094 | 2.14 |
| CPBPE 100X400 | 100 | 4" | 400 | 16" | 210095 | 3.27 |
| CPBPE 100X600 | 100 | 4" | 600 | 24" | 210096 | 4.08 |

2x +4/8

Pokrywa zakrętu TCPBPE

poziomego



| TCPBPE | B | | C | | PVC M1 UV | KG/UD |
|------------|-----|------|-----|--------|---------------|-------------|
| | mm | inch | mm | inch | | |
| TCPBPE 100 | 100 | 4" | 220 | 8 4/5" | 210097 | 0.18 |
| TCPBPE 150 | 150 | 6" | 220 | 8 4/5" | 210098 | 0.26 |
| TCPBPE 200 | 200 | 8" | 220 | 8 4/5" | 210099 | 0.43 |
| TCPBPE 300 | 300 | 12" | 220 | 8 4/5" | 210100 | 0.71 |
| TCPBPE 400 | 400 | 16" | 220 | 8 4/5" | 210101 | 1.12 |
| TCPBPE 600 | 600 | 24" | 240 | 9 1/2" | 210102 | 1.94 |

Kąt wznoszący 90° CCBPE



| | | | | | | | | |
|---------------|-----|--------|-----|-----|-----|---------|---------------|-------------|
| CCBPE 60X100 | 60 | 2 2/5" | 100 | 4" | mm | inch | 210103 | 0.39 |
| CCBPE 60X150 | 60 | 2 2/5" | 150 | 6" | 240 | 9 1/2" | 210104 | 0.49 |
| CCBPE 60X200 | 60 | 2 2/5" | 200 | 8" | 240 | 9 1/2" | 210105 | 0.78 |
| CCBPE 60X300 | 60 | 2 2/5" | 300 | 12" | 240 | 9 1/2" | 210106 | 1.19 |
| CCBPE 100X200 | 100 | 4" | 200 | 8" | 275 | 10 5/6" | 210107 | 1.37 |
| CCBPE 100X300 | 100 | 4" | 300 | 12" | 275 | 10 5/6" | 210108 | 1.98 |
| CCBPE 100X400 | 100 | 4" | 400 | 16" | 275 | 10 5/6" | 210109 | 2.55 |
| CCBPE 100X600 | 100 | 4" | 600 | 24" | 275 | 10 5/6" | 210110 | 3.23 |

2x +4/8

Pokrywa kąta TCCBPE

wznoszącego



| TCCBPE | B | | PVC M1 UV | KG/UD |
|----------------|-----|------|---------------|-------------|
| | mm | inch | | |
| TCCBPE 60X100 | 100 | 4" | 210111 | 0.18 |
| TCCBPE 60X150 | 150 | 6" | 210112 | 0.24 |
| TCCBPE 60X200 | 200 | 8" | 210113 | 0.37 |
| TCCBPE 60X300 | 300 | 12" | 210114 | 0.52 |
| TCCBPE 100X200 | 200 | 16" | 210115 | 0.56 |
| TCCBPE 100X300 | 300 | 12" | 210116 | 0.61 |
| TCCBPE 100X400 | 400 | 16" | 210117 | 0.81 |
| TCCBPE 100X600 | 600 | 24" | 210118 | 1.04 |

Odgaźnik PDBPE



| PDBPE | KG/UD |
|-----------|---------------------------|
| PDBPE 60 | 223021 0.24 |
| PDBPE 100 | 223022 0.48 |

2/4



Kąt opadający 90° CXBPE



| | | | | | mm | inch | PVCM1 UV | KG/UD |
|---------------|-----|--------|-----|-----|-----|--------|----------|-------|
| CXBPE 60X100 | 60 | 2 2/5" | 100 | 4" | 100 | 4" | 210119 | 0.39 |
| CXBPE 60X150 | 60 | 2 2/5" | 150 | 6" | 100 | 4" | 210120 | 0.49 |
| CXBPE 60X200 | 60 | 2 2/5" | 200 | 8" | 100 | 4" | 210121 | 0.78 |
| CXBPE 60X300 | 60 | 2 2/5" | 300 | 12" | 100 | 4" | 210122 | 1.19 |
| CXBPE 100X200 | 100 | 4" | 200 | 8" | 115 | 4 5/8" | 210123 | 1.37 |
| CXBPE 100X300 | 100 | 4" | 300 | 12" | 115 | 4 5/8" | 210124 | 1.98 |
| CXBPE 100X400 | 100 | 4" | 400 | 16" | 115 | 4 5/8" | 210125 | 2.55 |
| CXBPE 100X600 | 100 | 4" | 600 | 24" | 115 | 4 5/8" | 210126 | 3.23 |

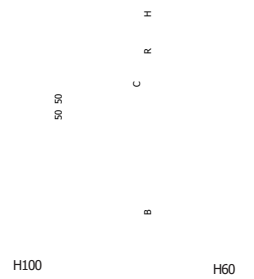

Pokrywa kąta wznoszącego TCXBPE



| | mm | inch | | |
|----------------|-----|------|--------|------|
| TCXBPE 60X100 | 100 | 4" | 210127 | 0.22 |
| TCXBPE 60X150 | 150 | 6" | 210128 | 0.30 |
| TCXBPE 60X200 | 200 | 8" | 210129 | 0.49 |
| TCXBPE 60X300 | 300 | 12" | 210130 | 0.65 |
| TCXBPE 100X200 | 200 | 16" | 210131 | 0.75 |
| TCXBPE 100X300 | 300 | 12" | 210132 | 0.82 |
| TCXBPE 100X400 | 400 | 16" | 210133 | 1.14 |
| TCXBPE 100X600 | 600 | 24" | 210134 | 1.39 |

Końcówka CCBPE



| | | | | | | |
|---------------|-----|--------|-----|-----|--------|------|
| TFBPE 60X100 | 60 | 2 2/5" | 100 | 4" | 223023 | 0.09 |
| TFBPE 60X150 | 60 | 2 2/5" | 150 | 6" | 223024 | 0.13 |
| TFBPE 60X200 | 60 | 2 2/5" | 200 | 8" | 223025 | 0.15 |
| TFBPE 60X300 | 60 | 2 2/5" | 300 | 12" | 223026 | 0.21 |
| TFBPE 100X200 | 100 | 4" | 200 | 8" | 223027 | 0.24 |
| TFBPE 100X300 | 100 | 4" | 300 | 12" | 223028 | 0.31 |
| TFBPE 100X400 | 100 | 4" | 400 | 16" | 223029 | 0.40 |
| TFBPE 100X600 | 100 | 4" | 600 | 24" | 223030 | 0.55 |



Przegroda PSBPE



| | 3M | | H | | PVCM1 UV | KG/M |
|------------|-------|--------|-----|--------|----------|------|
| | PSBPE | | mm | inch | | |
| PSBPE 60 | 60 | 2 2/5" | 60 | 2 2/5" | 210144 | 0.09 |
| TSPBPE 100 | 100 | 4" | 100 | 4" | 210145 | 0.13 |



| | mm | inch | PVCM1 UV | KG/UD |
|--------------|-----|--------|----------|-------|
| JUBPE-AB KIT | | | | |
| JUBPE-AB 60 | 60 | 2 2/5" | 223613 | 0.1 |
| JUBPE-AB 100 | 100 | 4" | 223614 | 0.2 |

| JUBPE | mm | inch | PVCM1 UV | KG/UD |
|-----------|-----|--------|---------------|-------------|
| JUBPE 60 | 60 | 2 2/5" | 210084 | 0.05 |
| JUBPE 100 | 100 | 4" | 210085 | 0.09 |

4/8

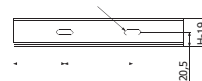

BPI JU 60

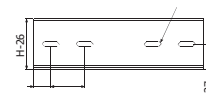

BPI JU 100

Śruba z nakrętką TCPBPE

| CTBP | PVCM1 UV | KG/UD |
|----------|---------------|-------------|
| CTBP-100 | 210017 | 0.40 |

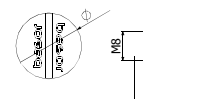

Łącznik środkowy JUBPE-C

| JUBPE | mm | inch | PVCM1 UV | KG/UD |
|---------|----|------|---------------|-------------|
| JUBPE-C | - | - | 218797 | 0.30 |

4



Uchwyt uchylny KSHGR

| KSHGR | GSP 7035 | KG/UD |
|-------|---------------|-------------|
| KSHGR | 217282 | 0.61 |

2/4

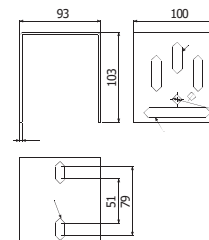

M10x100 DIN931
M10 DIN6923

10

Sworzeń do montażu wsporników poziomych w profilu PSHG.

BASORPLAST

Profil U

PSHG-PSHGR



| PSHG-PSHGR | | KG/UD |
|---------------------|---------------|-------------|
| PSHG 2M | 217281 | 2.29 |
| PSHGR 600 | 217283 | 2.05 |
| TFSHGR PVC zaślepka | 212112 | 0.25 |

Profil do montażu wsporników poziomych SHG.

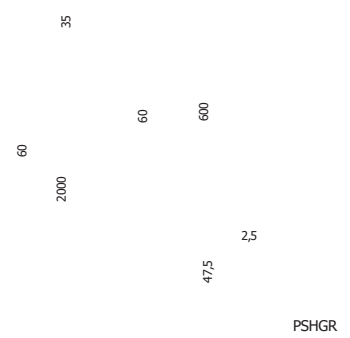

Rozpórka

BIK10-BPE

| | mm | i304 | KG/UD | i316 | KG/UD |
|----------------------|----------------|---------------|-------------|----------------|-------------|
| BIK10-BPE 60X100 | 1.5 60x100 | 217340 | 0.03 | 2/17347 | 0.03 |
| BIK10-BPE 60X150 | 1.5 60x150 | 217341 | 0.05 | 2/17348 | 0.05 |
| BIK10-BPE 60/100X200 | 1.5 60/100x200 | 217342 | 0.07 | 2/17349 | 0.07 |
| BIK10-BPE 60/100X300 | 1.5 60/100x300 | 217343 | 0.09 | 2/17350 | 0.09 |
| BIK10-BPE 100X400 | 2 100x400 | 217345 | 0.20 | 2/17352 | 0.20 |
| BIK10-BPE 100X600 | 2 100x600 | 217346 | 0.49 | 2/17353 | 0.49 |



Konsola pozioma

SHG

| SHG | mm | inch | | |
|---------|-----|------|---------------|-------------|
| SHG 100 | 100 | 4" | 210011 | 0.19 |
| SHG 150 | 150 | 6" | 210012 | 0.27 |
| SHG 200 | 200 | 8" | 210013 | 0.34 |
| SHG 300 | 300 | 12" | 210014 | 0.54 |
| SHG 400 | 400 | 16" | 210015 | 0.95 |
| SHG 600 | 600 | 24" | 210016 | 1.10 |

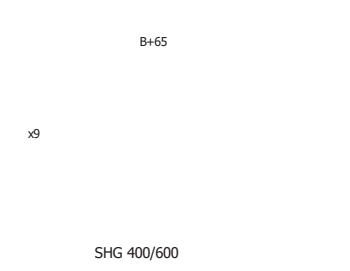
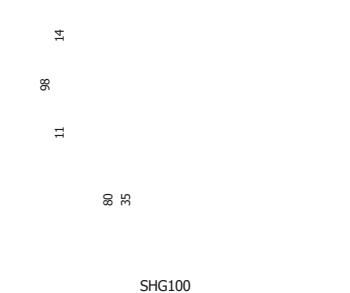
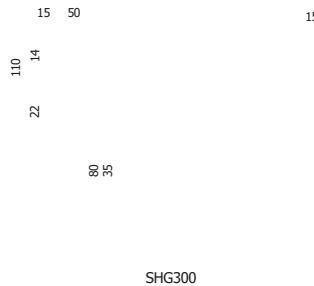
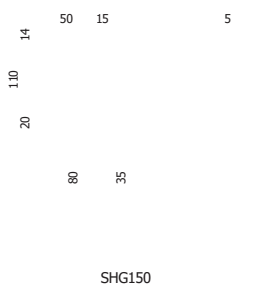

Konsola uniwersalna

SVG



| | | | | |
|---------|-----|-----|---------------|-------------|
| SVG 100 | 100 | 4" | 210050 | 0.23 |
| SVG 150 | 150 | 6" | 210051 | 0.26 |
| SVG 200 | 200 | 8" | 210052 | 0.28 |
| SVG 300 | 300 | 12" | 210053 | 0.33 |
| SVG 400 | 400 | 16" | 210054 | 0.38 |
| SVG 600 | 600 | 24" | 210055 | 0.48 |

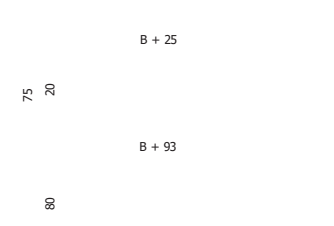

Konsola uniwersalna, pozioma i do podwieszania.

Dystrybutor w Polsce : **EL-QUINT** Sp. z o.o. www.elquint.com.pl

3E Basor
LE E I LI